

NOTE
 - Dimensions shown on drawing have been measured on site
 - Site boundaries shown in red correspond with deed plan

NORTH
 ↓

MONKTON STADIUM CAR PARK

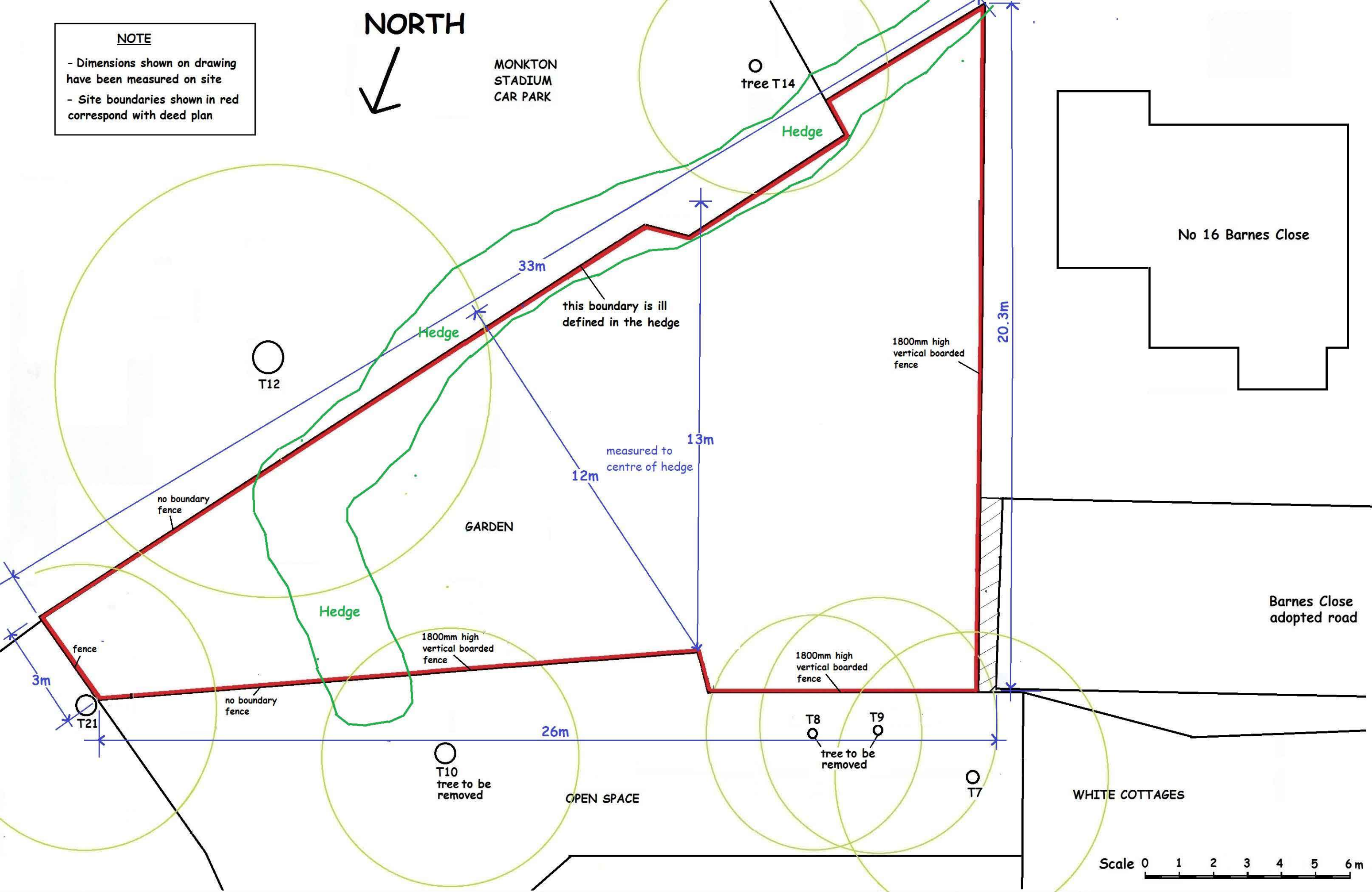

Scale 0 1 2 3 4 5 6 m

EXISTING SITE PLAN

PROPOSED HOUSE ON SITE AT BARNES CLOSE, MONKTON VILLAGE, JARROW

Scale : 1.100 @A3 size

Date : 20th Sept 2015

Drawing no :

G/60/00

David Leybourne R.I.B.A.
 Chartered Architect
 Sandybank, Fintree, Crook, Co Durham. DL158EB
 Tel : 01388764541 / 07709863813